

SC 160 I

Self-contained LED lantern for buoys and beacons

SC 160 I is a self-contained medium range LED lantern with best-in-class optical performance for fixed and floating structures. The lantern includes solar panels, battery and charge controller. This lantern is designed for harsh marine environments and for long uninterrupted operation.

- Range up to 8 NM (Tc=0,74) 11 NM (Tc=0,85) depending on geographical location
- Standard IALA colours red, green, white, yellow
- Lantern made of rugged injection moulded aluminium housing and UV resistant polyethylene body
- Integrated flasher with day-light switch and solar charger
- Standard VRLA battery and ventilated battery compartment , Li-ion battery optional
- Solar modules covered with tempered glass
- Adjustable intensity and range
- Available with narrow (5°) or wide (10°) vertical divergence
- Programmable with Bluetooth® Control mobile app up to 50 m radius
- Other wireless programming options available such as Sabik Easy Programmer or PC/USB interface
- Integrated event log for 365 days
- Optional integrated GPS synchronization and GSM Remote monitoring
- Available with AIS
- External charge port or external solar module



Integrated AIS

- Available in two models: Type 1 (FATDMA) and Type 3 (RATDMA)
- AIS transponder integrated in the top part of the lantern
- Integrated GPS antenna and external VHF antenna included in the delivery
- Extremely low power consumption when used as Type 1 <45mW with 1 message/3 minutes (about 0,09 Ah/day)
- Support messages: 6 and 21
- Supports up to 10 virtual Aton:s

Optical Performance

Maximum fixed intensity SC 160 IN (5° @ 50% peak intensity FWHM)

	1150 cd	1200 cd	1000 cd	1850 cd
Power consumption	13 W	16 W	16 W	16 W

Maximum fixed intensity SC 160 IW (10° @ 50% peak intensity FWHM)

	620 cd	720 cd	620 cd	1100 cd
Power consumption	13 W	16 W	16 W	16 W

Main Technical Specification

Lens visual/Mechanical diameter	160 mm
Lens material	UV stabilized acrylic
Light source	High Power Light Emitting Diodes (LEDs)
Vertical divergence options	5°@50% of peak intensity (FWHM) 10°@50% of peak intensity (FWHM)
Solar modules	3 x 10 W
Battery	VRLA GEL-Type, 32Ah/12V; Li-ion 35Ah/12V
Weight	27 Kg
Overall height	583 mm
Overall width	431 mm dia.
Power consumption	13W - 16W
Installation	3 x M12 on 330 mm dia.

Self-contained
Lanterns

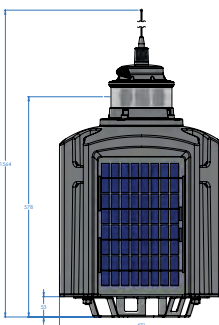
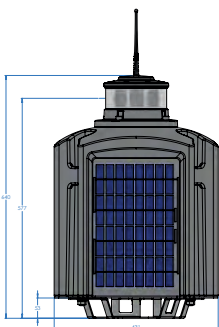
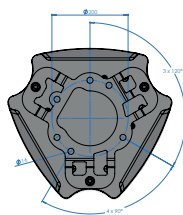
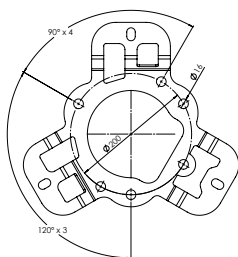

Order Overview SC 160 I

SC160 I with VRLA Battery

N = Narrow (5° @ 50 % peak intensity)		W = Wide (10° @ 50 % peak intensity)	
Red	SC-160-1-NVR	Red	SC-160-1-WVR
Yellow	SC-160-1-NVY	Yellow	SC-160-1-WVY
Green	SC-160-1-NVG	Green	SC-160-1-WVG
White	SC-160-1-NVW	White	SC-160-1-WVW

Example: SC160-1-WVW-4L

- **SC-160-1-WVW** is the code for SC160 I with VRLA battery and wide lens in white
- **4L** is a selection for option 4L Integrated GPS sync including GPS antenna

Option matrix

GPS sync	Integrated GPS sync including GPS antenna
OPT 4L	
LightGuard GSM + GPS	Integrated GSM/GPS based monitoring including GSM/GPS antennas
OPT 9L	
OPT 11L	Control card for secondary (emergency) battery
Automatic Identification System	OPT AIS 1: Lantern with integrated AIS type 1 OPT AIS 3: Lantern with integrated AIS type 3